

WISE-52xx / WISE-224x System Restore Manual v1.0.5

During the operation of WISE-52xx and WISE-224x, if the system encounters any abnormal problem that you would like to reset the WISE-52xx and WISE-224x to factory default, please follow the steps below:

Please note: The process will clear all settings of WISE-52xx / WISE-224x.

1. Power off WISE-52xx/WISE-224x and remove the microSD card from WISE-52xx/WISE-224x, and insert the microSD card into the PC. If your PC does not provide the slot for microSD card, please remember to prepare a card reader and connect it to the PC for the microSD card.
2. Insert the CD (you can find it in the package of WISE-52xx/WISE-224x) into the CD-ROM of the PC. Copy the “WISE-52xx_224x Installer.zip” file from “CD_ROM : \WISE-52xx\ installation file” directory to PC, uncompress it and you will find the “WISE-52xx_224x Installer” directory. Copy the whole “WISE-52xx_224x Installer” directory from PC to the root directory of the microSD card. You can also download the “WISE-52xx_224x Installer.zip” file from “<http://wise.icpdas.com/Download.html>”.
3. Get the WISE-52xx/WISE-224x firmware from the “CD_ROM : \WISE-52xx\firmware” and “CD_ROM : \WISE-224x\firmware” directory or visit “<http://wise.icpdas.com/Download.html>” to download the latest version of WISE-52xx/WISE-224x firmware, then copy the firmware files you get to the “microSD\WISE-52xx_224x Installer\firmware” directory. After complete all setting, please remove the microSD card from PC and insert it into the WISE-52xx/WISE-224x.
4. Connect Mouse and monitor to WISE-52xx/WISE-224x, then power on WISE-52xx/WISE-224x. Use Mouse to double click the “My Device” icon on the desktop and “Micro_SD” icon, now you can find the “WISE-52xx_224x Installer” directory. Enter the directory and double click “WISE-52xx_224x Installer.exe” file to launch the process to reset the WISE-52xx/WISE-224x to factory default.

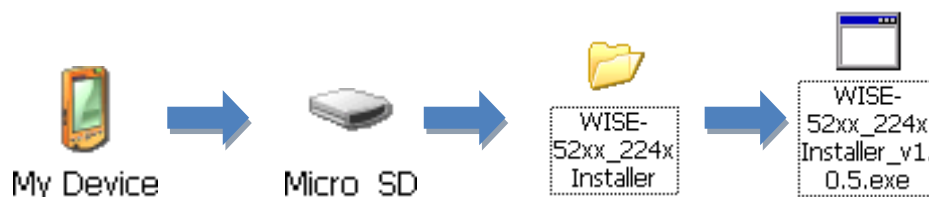

The process is described as below.

- Select the correct firmware version which will be used in the installation.

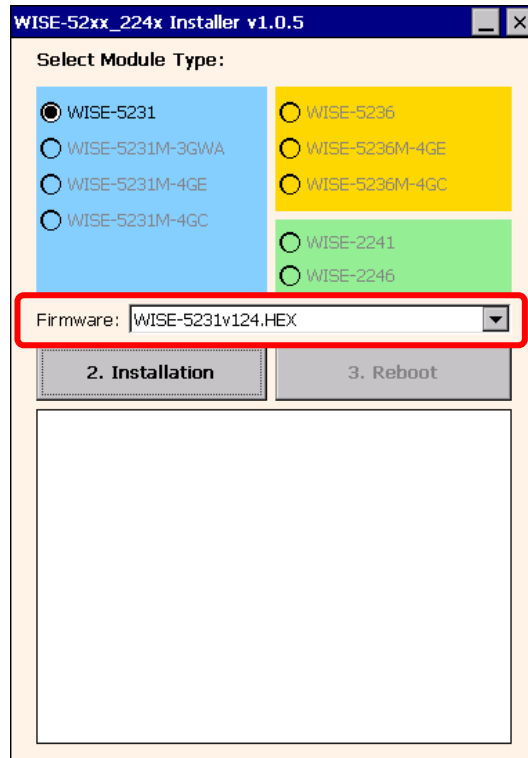

- Click the “2. Installation” button to start the process.

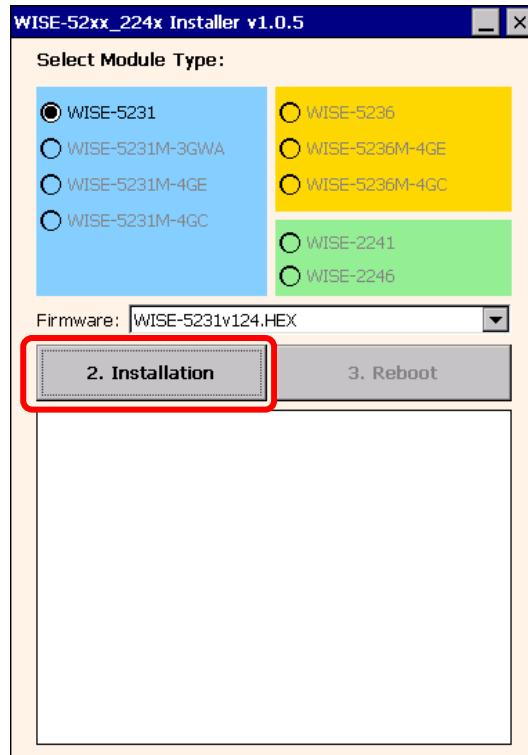

- When the process is finished, click the “3. Reboot” button to reboot WISE-52xx/WISE-224x controller.

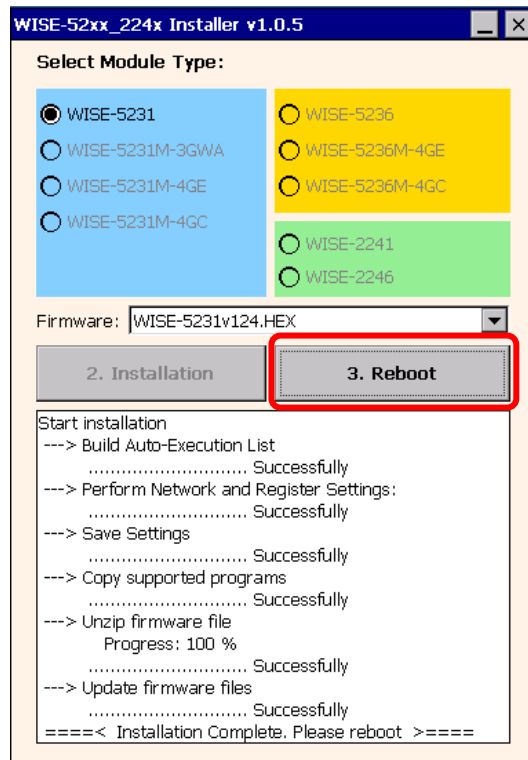

When the reboot process is finished, WISE-52xx/WISE-224x will return to factory default setting as below.

Item	Setting
IP Address	192.168.255.1
Subnet	255.255.0.0
Gateway	192.168.0.1
DNS	8.8.8.8
Default password for Administrator	Admin