



# I/O CARD QUICK START GUIDE

for

**A-822 Series**

*Language*  
*Version*  
*Update*

English  
V1.2  
Nov.2008

# 1

## What's on your package?

- One A-822 series card
- One companion ISA CD(V2.1 or later)
- One Quick Start Guide(this document)

# 2

## Installing Windows Driver

Follow those steps:

### I. Setup the Windows driver.



You can get the driver from:

CD:\NAPDOS\ISA\A822\DLL\_OCX\

[http://ftp.icpdas.com/pub/cd/iocard/isa/napdos/isa/A822/dll\\_ocx/](http://ftp.icpdas.com/pub/cd/iocard/isa/napdos/isa/A822/dll_ocx/)

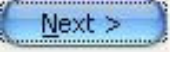
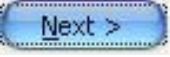

Windows driver only support windows 98/NT/2000 and XP/2003/vista 32-bit versions.

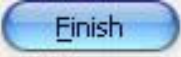
- II. Click  button to start installation.
- III. Click  button to install driver into the default folder.
- IV. Click  button to continue installation.
- V. Select **“NO, I will restart my computer later”** and then click  button.

# 3

## I/O Base Address/Interrupt Setting

➤ The base address is set from SW1 DIP switch on board:

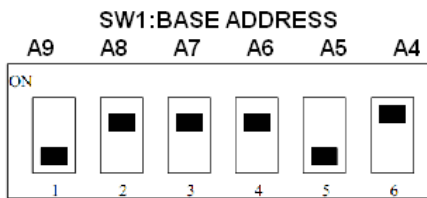

Default base address: 220

SW1: BASE ADDRESS VALUE TABLE (☑) : default base address is 0x220

BASE ADDR	A9	A8	A7	A6	A5	A4
200-20F	OFF	ON	ON	ON	ON	ON
210-21F	OFF	ON	ON	ON	ON	OFF
220-22F(☑)	OFF	ON	ON	ON	OFF	ON
230-23F	OFF	ON	ON	ON	OFF	OFF
:	:	:	:	:	:	:
300-30F	OFF	OFF	ON	ON	ON	ON
:	:	:	:	:	:	:
3F0-3FF	OFF	OFF	OFF	OFF	OFF	OFF

➤ The Interrupt Level Setting

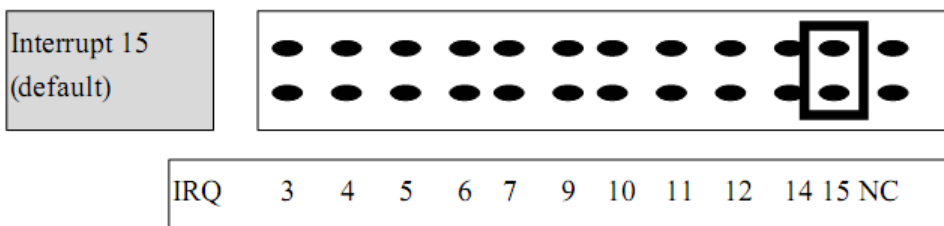

# 4

## Installing Hardware on PC

Follow those steps:

1. Shut down and power off your computer
2. Remove all covers from the computer
3. Select an empty ISA slot
4. Carefully insert your I/O card into the ISA slot
5. Replace the PC covers
6. Power on the computer

After powering-on the computer, continue next process.

# 5

## Adding Hardware



Adding hardware is used on Windows 2000/XP/2003/Vista 32 only. Windows 9X/Me/NT users can skip it.

---

### 7. Add Hardware

- 7-1 Open the **“Control Panel”** by click the item **“Start / Settings / Control Panel”**.
- 7-2 Double-click the item **“Add/Remove Hardware”** and Click the **“Next >”** button.
- 7-3 Select the item **“Add/Troubleshoot a device”** and click the **“Next >”** button.
- 7-4 Select the item **“Add a new device”** and click the **“Next >”** button.

- 7-5 Select the item **“No, I want to select the hardware from a list”** and click the **“Next >”** button.
- 7-6 Select the item **“Other device”** and click the **“Next >”** button.
- 7-7 Click the **“Have Disk...”** button.
- 7-8 Click the **“Browse...”** button to select the Inf file default path is C:\DAQPRO\A822\_Win2K\Inf and click the **“OK”** button.
- 7-9 Select the correct device from the **“Models:”** listbox and Click the **“Next >”** button.
- 7-10 The windows show to dialog box and Click the **“OK”** button to enter the device’s properties settings.

## 8. Modify the device properties

The image shows a sequence of four steps for modifying device properties:

- 1. Select Input/Output Range**: In the 'Resources' tab of the 'ICPDAS A-822 Analog/Digital Card Properties' dialog, the 'Input/Output Range' is selected in the 'Resource type' list.
- 2. Click “Change Setting” to change I/O Range (Depend on I/O Base Address)**: The 'Change Setting...' button is clicked, opening the 'Edit Input/Output Range' dialog. The 'Value' is set to '0220 - 022F' and the 'Conflict information' box states 'No devices are conflicting'.
- 3. Select Interrupt Request**: In the 'Resources' tab, the 'Interrupt Request' is selected in the 'Resource type' list.
- 4. Click “Change Setting” to change Interrupt Request. (Depend on Interrupt Level setting)**: The 'Change Setting...' button is clicked, opening the 'Edit Interrupt Request' dialog. The 'Value' is set to '07' and the 'Conflict information' box states 'No devices are conflicting'.

## 9. Reboot the PC

The detail “add hardware” information please refer to

CD:\NAPDOS\ISA\Manual\PCI\_ISA\_PnP\_Driver\_Installation\_in\_Win9x\_2K\_XP.pdf

# 6

## Pin Assignments

**CN1**

DI 0	1	2	DI 1
DI 2	3	4	DI 3
DI 4	5	6	DI 5
DI 6	7	8	DI 7
DI 8	9	10	DI 9
DI 10	11	12	DI 11
DI 12	13	14	DI 13
DI 14	15	16	DI 15
D.GND	17	18	D.GND
5V +	19	20	12V +

**CN2**

DO 0	1	2	DO 1
DO 2	3	4	DO 3
DO 4	5	6	DO 5
DO 6	7	8	DO 7
DO 8	9	10	DO 9
DO 10	11	12	DO 11
DO 12	13	14	DO 13
DO 14	15	16	DO 15
D.GND	17	18	D.GND
5V +	19	20	12V +



CN1& CN2 are  
TTL compatible

**CN3**

Pin	Description	Pin	Description
1	AI 0/+	20	AI 8/+
2	AI 1/+	21	AI 9/+
3	AI 2/+	22	AI 10/+
4	AI 3/+	23	AI 11/+
5	AI 4/+	24	AI 12/+
6	AI 5/+	25	AI 13/+
7	AI 6/+	26	AI 14/+
8	AI 7/+	27	AI 15/+
9	Analog GND(-)	28	Analog GND(-)
10	Analog GND(-)	29	Analog GND(-)
11	D/A internal -5/-10V reference Output	30	D/A channel 0 output
12	D/A channel 1 external reference input	31	D/A channel 0 external reference input
13	PCB +12V	32	D/A channel 1 output
14	Analog GND(-)	33	User timer/counter GATE control input
15	Analog GND(-)	34	Timer/counter 1&2 GATE control input
16	User timer/counter output	35	Timer/counter 1 output
17	Ext trigger source input/TTL	36	Reserved
18	Reserved	37	User timer/counter EXT clock input
19	PCB +5V		

**TTL Range**

<b>High(1)</b>	<b>2.4V ~5.0V</b> <b>(Voltages over 5.0V will damage the device)</b>
<b>None Defined</b>	<b>2.4V~0.8V</b>
<b>Low(0)</b>	<b>Under 0.8V</b>

# 7

## Self-Test

- I. Use CA-2002(Optional) to connect the CN1 with CN2

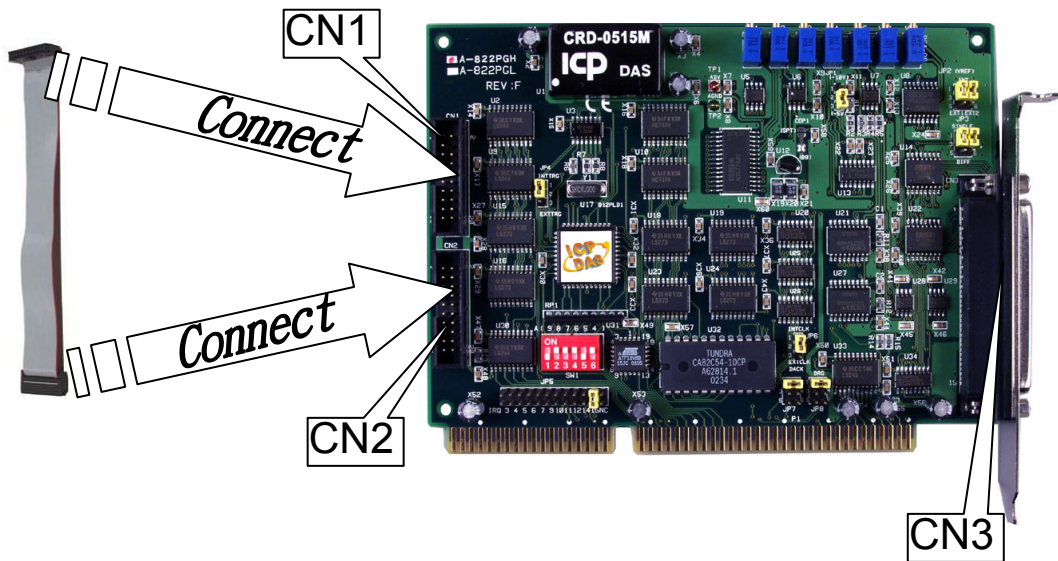

- II. Run the DIO sample program.

Get the file from:

CD:\NAPDOS\ISA\A822\dll\_ocx\

[http://ftp.icpdas.com/pub/cd/iocard/isa/napdos/isa/a822/dll\\_ocx/](http://ftp.icpdas.com/pub/cd/iocard/isa/napdos/isa/a822/dll_ocx/)

- III. Check number of the A-822, and test DIO function

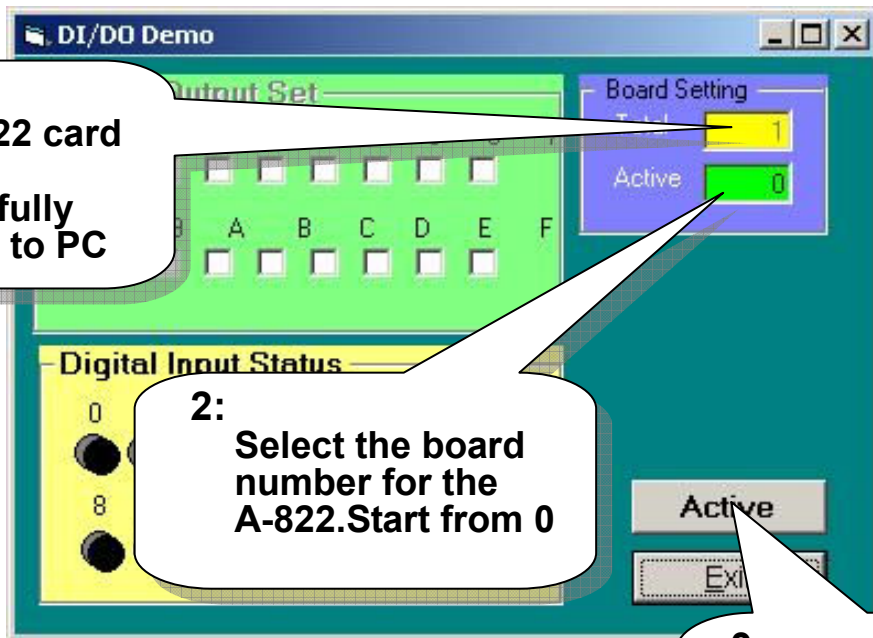

1: One A-822 card had successfully installed to PC

2: Select the board number for the A-822. Start from 0

3: Click this button to do DIO function test

#### IV. Get DIO function test result

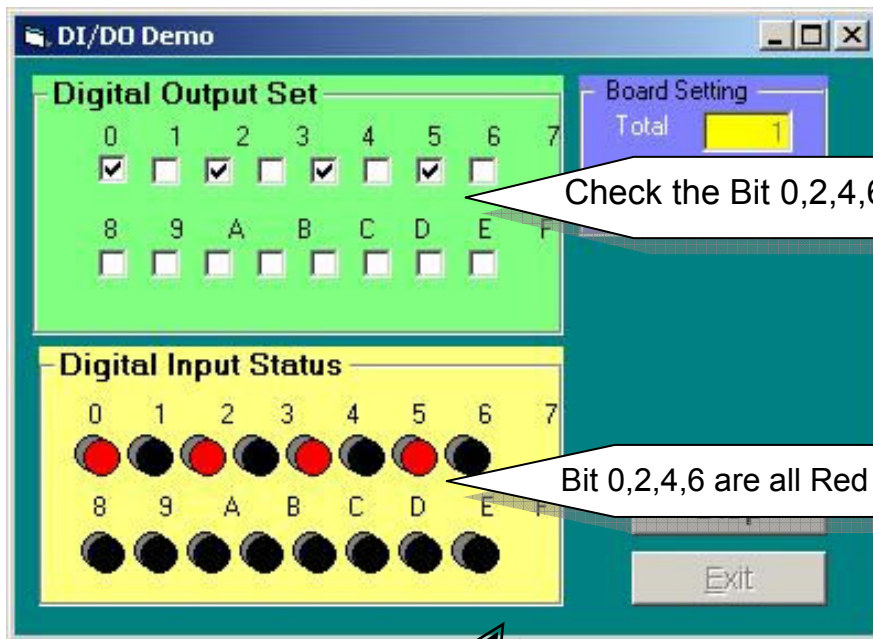

Check the Bit 0,2,4,6 CheckBox.

Bit 0,2,4,6 are all Red light. Pass!!!



# 8

## Additional Information

✓ A-822 Series Card Product page:

[http://www.icpdas.com/products/DAQ/pc\\_based/a-822.htm](http://www.icpdas.com/products/DAQ/pc_based/a-822.htm)

✓ CA-2002(Optional) page:

[http://www.icpdas.com/products/Accessories/cable/cable\\_selection.htm](http://www.icpdas.com/products/Accessories/cable/cable_selection.htm)

✓ Documents:

CD:\NAPDOS\ISA\A822>manual

CD:\NAPDOS\ISA\Manual

<http://ftp.icpdas.com/pub/cd/iocard/isa/napdos/isa/a822/manual/>

✓ Software:

CD:\ISA\NAPDOS\ISA\A822

<http://www.icpdas.com/download/isa/a822/index.htm>

### The ICP DAS Web Site

<http://www.icpdas.com>



- Technical support
- Supplies and ordering information
- Ways to enhance your device
- FAQ
- Application story

### Contact Us

[Service@icpdas.com](mailto:Service@icpdas.com)

Copyright ©2008 by ICP DAS Co., Ltd. All right are reserved